

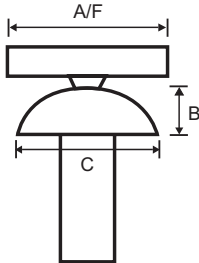

Shear Bolt - A2 Stainless Steel



Dimensions (mm)

DIMENSIONS \ SIZE	M6	M8	M10	M12
AF	10.0	14.0	17.0	19.0
B	3.5	4.5	5.5	6.5
C	9.5	13.5	16.5	18.5

Material and Finish

Material:	A2 Stainless Steel
Heat Treatment:	None
Finish:	Self Colour

Part Numbers & Shear Torque

SIZE	M6	M8	M10	M12
SHEAR TORQUE (nm)	7-14	14-25	30-42	52-65

Additional Information

Installation:	Uses standard hex spanner or socket
Removal:	1-Way Permanent fixing only
Security Rating:	4 out of 5 High Security

- ✓ High security permanent fixing
- ✓ Installed using standard tools
- ✓ Leaves a tamper resistant cone

Every effort has been made to ensure the accuracy of information provided in this datasheet. Hafren Fasteners cannot warrant the information however, expressly or implied, and any liability arising from it is expressly excluded. Customers must satisfy themselves as to the suitability of products and the technical information relating to them, and it is recommended that you conduct your own tests to establish suitability. All sizes shown are in mm without min and max tolerances and are guide sizes. Hafren Fasteners reserve the right to change/alter sizes without notice. This does not effect your statutory rights.